



PFT8857

Installation Guide

Installationsanleitung, Guía de Instalación, Guida de Installazione, Guide d'Installation, Installatie gids





PFT8857 Installation Guide

Installationsanleitung, Guía de Instalación, Guida de Installazione, Guide d'Installation, Installatie gids

Included components

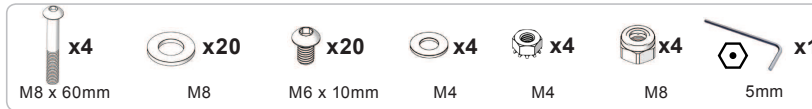

Required for installation



If this is a "one man" installation find a "friendly" clear flat wall to place one leg assembly along side. Place the lower pan panel on top of the legs channel between the "upright". Next place the second leg over the lower pan panel so all four through holes line up and loosely secure the lower pan to the legs with the four M8 x 1.25 x 60mm "button head Allen head screws and M8 flat washers supplied.

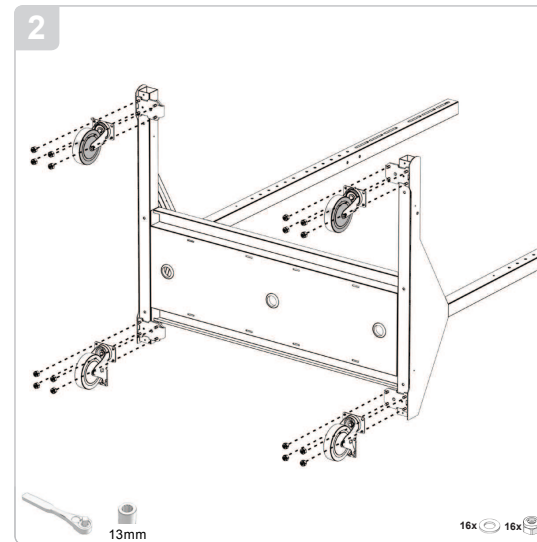
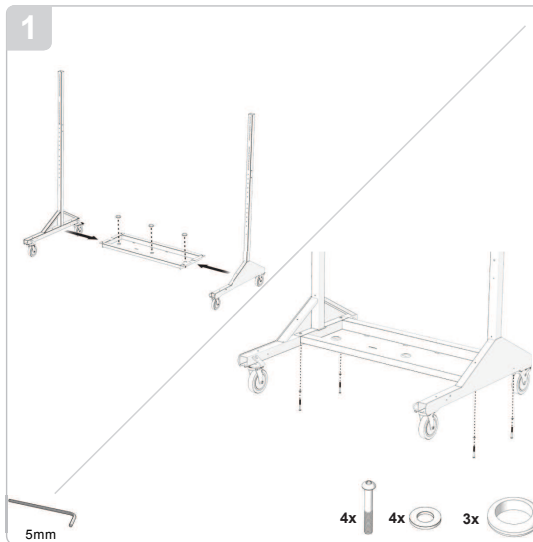

Laying the paired leg assembly first on its back and then on its front securely install the four casters on the front and rear of the leg assemblies using the M8 flat washers and M8 self locking nuts supplied. Then securely install the four casters. We recommend the two rear caster be the "locking pair"



PFT8857 Installation Guide

Installationsanleitung, Guía de Instalación, Guida de Installazione, Guide d'Installation, Installatie gids

Loosely install the front upper cover to the front of the cart with the four M6 x 1.0 x 10mm "button head" Allen screws supplied.

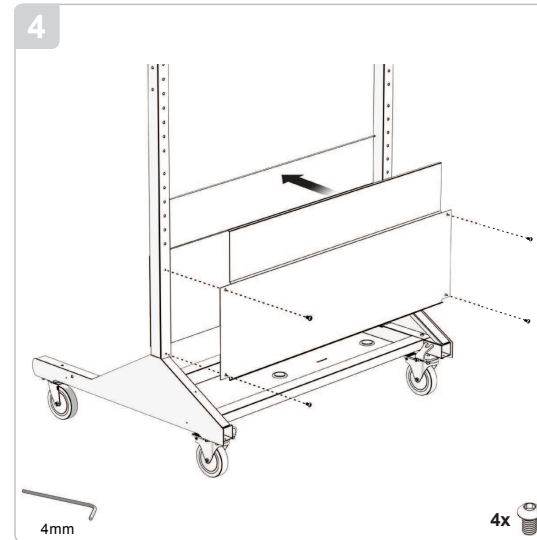
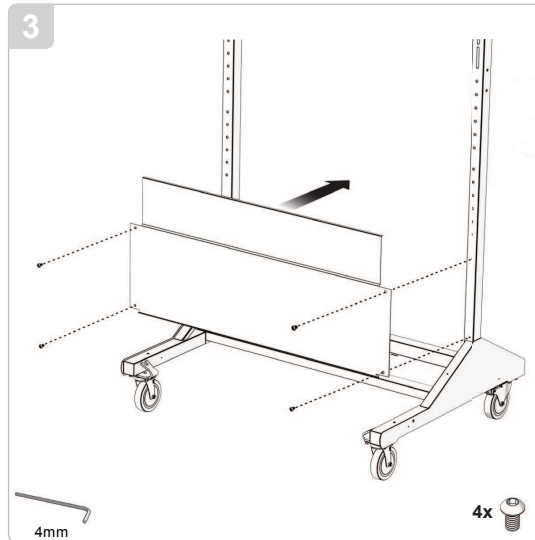

Repeat the same procedure with the upper rear panel to the leg assembly with the four each "button head" Allen screws supplied.

Now secure firmly the four lower pan "button head" screws to the leg assembly and tighten firmly. Repeat the same process with the front and rear upper cover panels but "don't" over-tighten these.

Install the front "logo" plate to the lower panel cover with the four each 10/32 x 1/2" "kep" nuts and flat washers supplied.

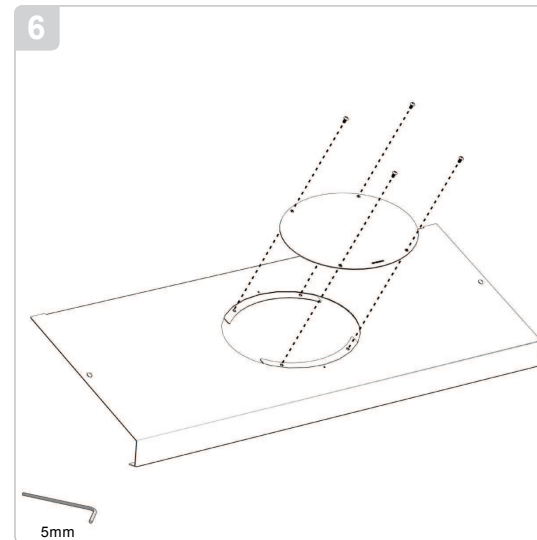
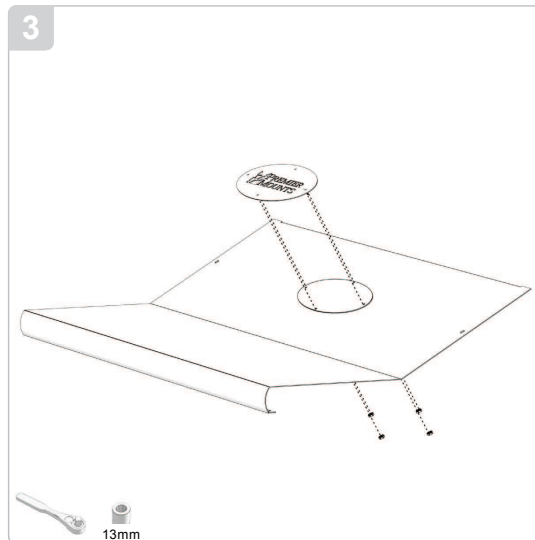

The rear oval panel cover can be installed before or after final assembly of the cart with the four each M6 button head Allen head screws supplied.



PFT8857 Installation Guide

Installationsanleitung, Guía de Instalación, Guida de Installazione, Guide d'Installation, Installatie gids

Install the lower front panel cover to the frame front and secure to the frame assembly with the four each M6 x 1.0 x 10mm "button head" Allen head screws supplied

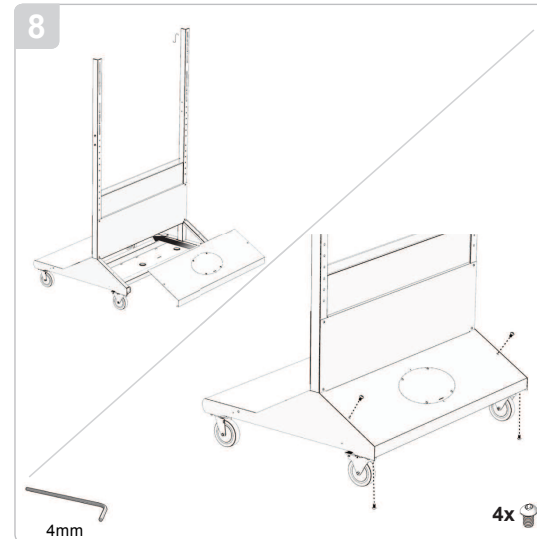
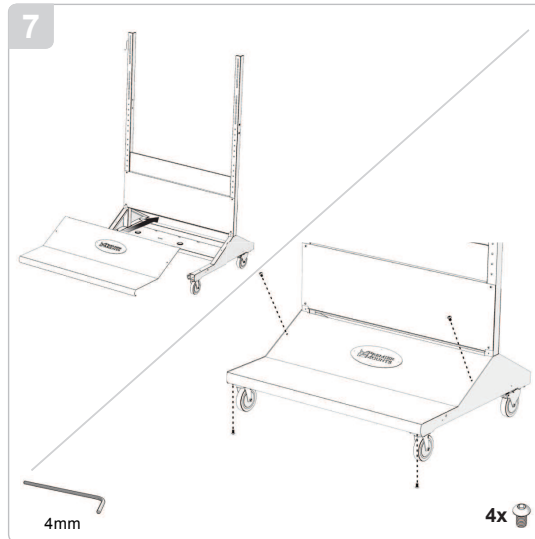

With the rear of the lower pan exposed now would be the time to place and wire any powered support products feeding the display with the power and signal cable being fed between the front and rear upper cover panels. Power and signal cable can also be run up through the three rubber grommet hole in the base of the pan as well. Once housed the rear cover panel may now be installed with the four "button head" Allen screws supplied. Access to the inner pan is still available through the rear oval access cover.

Two people recommended for this portion of the "mega" cart assembly process. Raise the receiver cross bar assembly to the desired "centerline" height and secure to the uprights firmly with the four "button head" Allen screws and flat washers supplied.

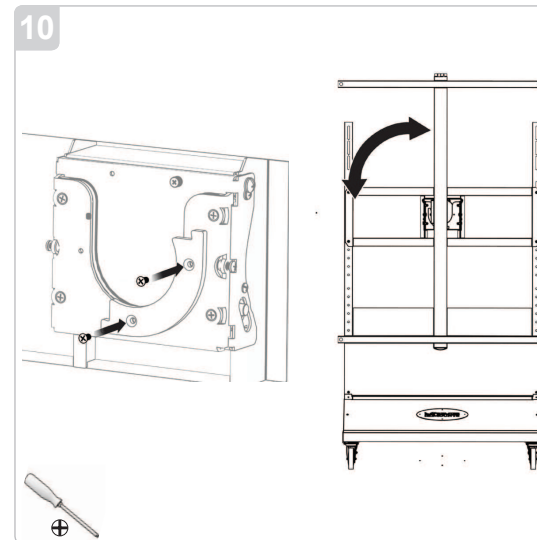
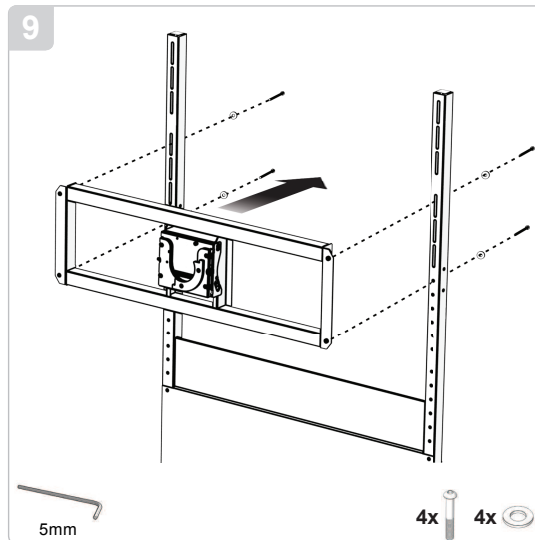

The 90 degree rotation stop can be installed to allow for left or right rotation of the arm only. Simply remove the two M6 flat head screw to reposition the 90 degree stop plate and reinstall

PFT8857 Installation Guide

Installationsanleitung, Guía de Instalación, Guida de Installazione, Guide d'Installation, Installatie gids

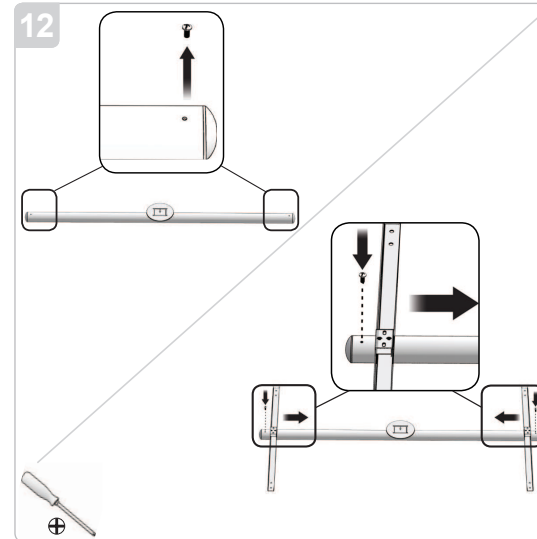
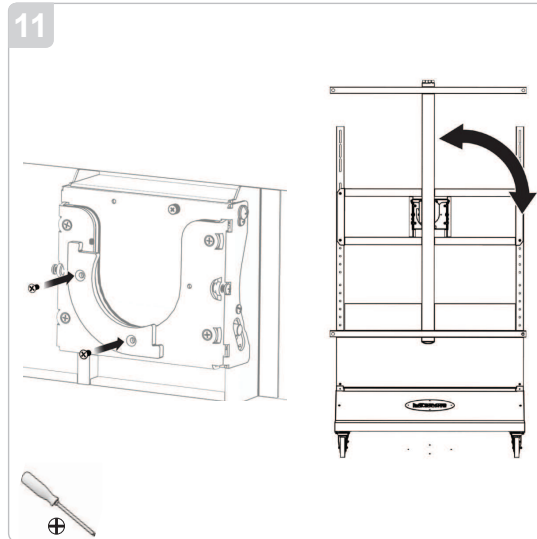

Slide the left and right display mounting brackets over the cross bar and install the left and right M6 x 1.0 x 12mm security Phillips head screws supplied into the cross bar.

With the display safely positioned "face down" on a smooth flat surface place the cross bar with brackets loosely attached so the center of the round receiver is center on the display left to right and top to bottom.

Slide the left and right mounting bracket over the left and right mounting holes (normally four each) and firmly install the brackets to the display with the correct length M8 x 1.25 Phillips head screw supplied. Note: measure the depth of the threaded mounting hole to confirm the correct length of the M8 screws from the three lengths supplied. Confirm the crossbar is still centered left to right on the rear of the display and firmly secure the bracket to the cross bar with the four M6 x 1.0 x 10mm Allen head set screws supplied.

Eight optional use M4 - M8 plastic spacer are included in the hardware kit if needed to create clearance between the mounting bracket and the display. These spacers easily joined together for additional height is needed as well.

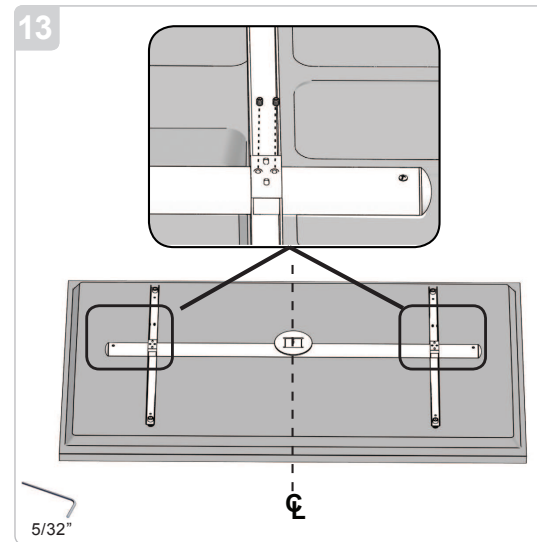
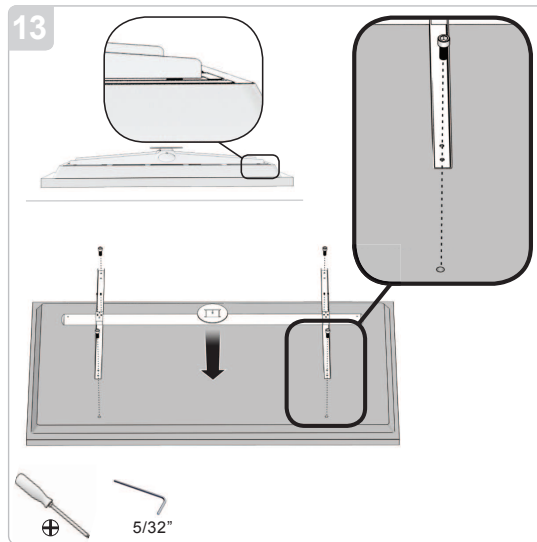



PFT8857 Installation Guide

Installationsanleitung, Guía de Instalación, Guida de Installazione, Guide d'Installation, Installatie gids

Remove the M6 security holding screw from the receiver and set to the side for re-install after the crossbar and display are installed into the receiver slots.

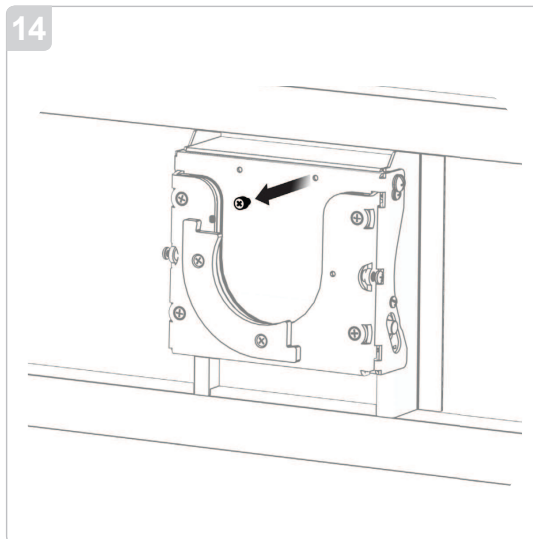

Re-install the M6 security screw.

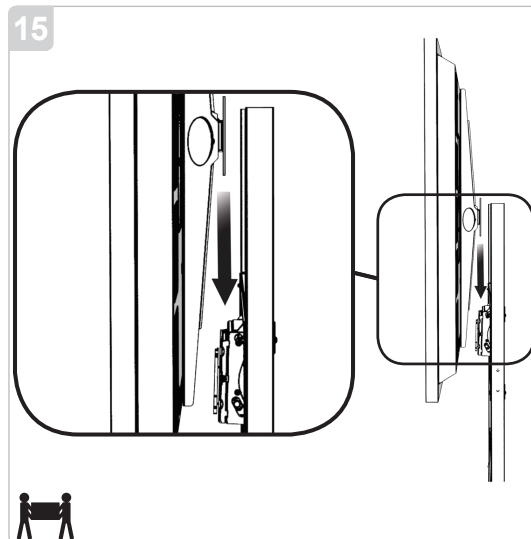
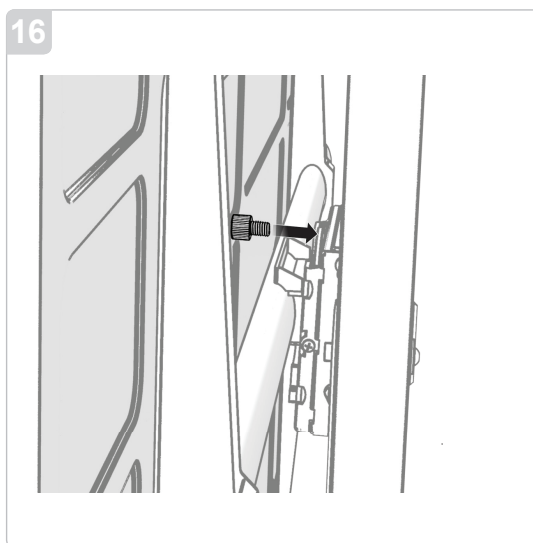

Depending on the size and weight of the display use appropriate number or personal and lift assistance device to raise and slowly install the round center of the cross bar into the round receiver chassis and insure it is fully seated in the receiver chassis.

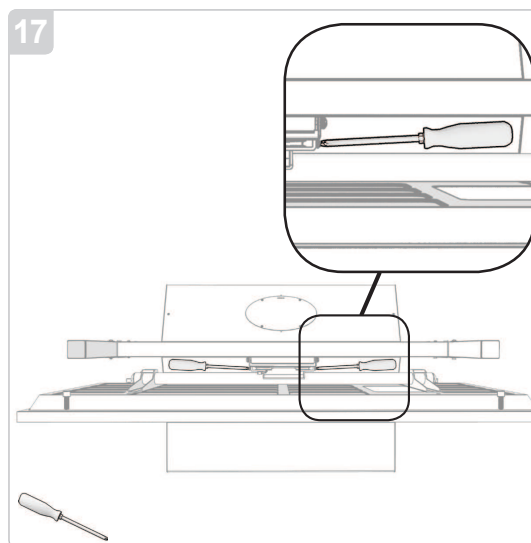

Friction of the rotation can be adjusted by increasing or decreasing the friction screw on either side of the receiver assembly penetration of the two installed friction screw with a Phillips head screwdriver.



PFT8857 Installation Guide

Installationsanleitung, Guía de Instalación, Guida de Installazione, Guide d'Installation, Installatie gids

Vertical flatness of the installed display can be adjusted using an M10 socket and ratchet on the lower "head assembly". IT helps if someone is gently lifting "out" on the lower display as the "tilt in" adjustment is made.

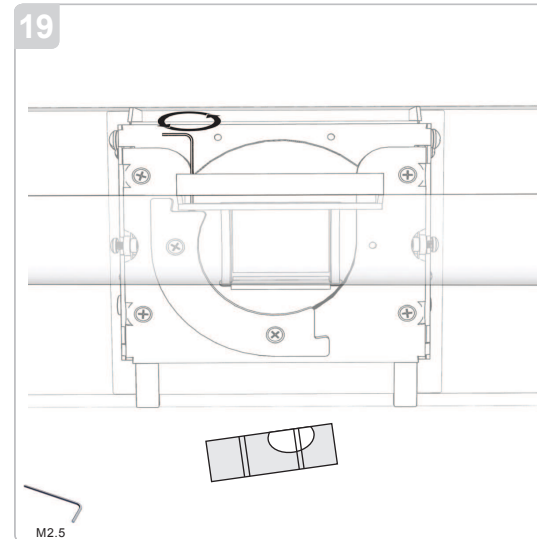
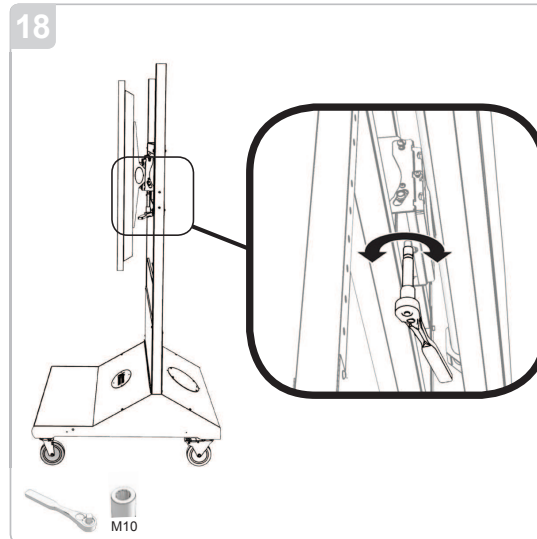

With the 2.5mm Allen head wrench supplied install the two each M5 x 6mm mini adjustment Allen head screws supplied to both sides of the "rotation" stop bar. slowly turn the display to the level position in each direction and adjust the two adjust screw to set max rotation in each direction to level.



PFT8857 Installation Guide

Installationsanleitung, Guía de Instalación, Guida de Installazione, Guide d'Installation, Installatie gids

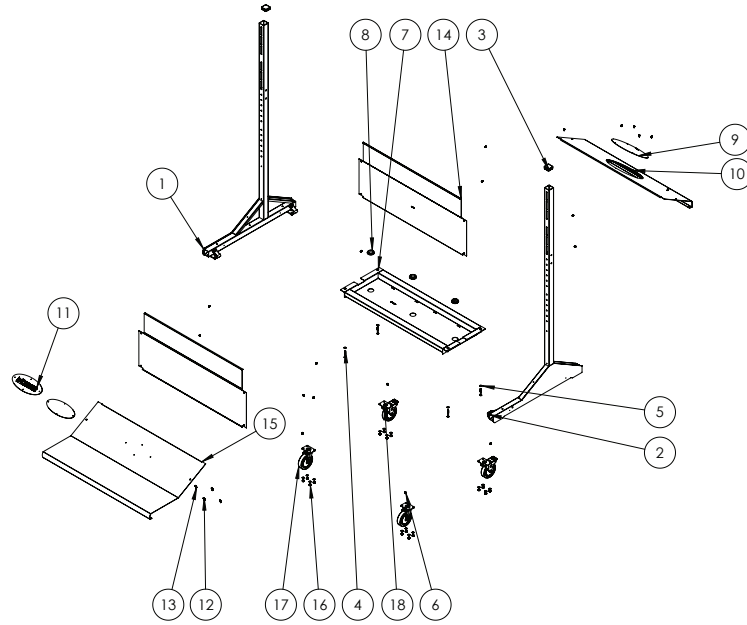

ITEM NO.	QTY.	PART NO.	REV.	DESCRIPTION
1	1	3201-000-010-XX	02	VERTICAL LEFT LEG ASSEMBLY 2X2
2	1	3201-000-020-XX	02	VERTICAL RIGHT LEG ASSEMBLY 2X2
3	2	0725-DCG-W02-13		PLUG PUSH-IN RIBBED SQUARE CAP 2 X 2"
4	4	0411-079-320-6X		SCREW BUTTON HEX (M8 x 1.25 x 60)
5	20	198X-507-600-50		WASHER M8 (.335 ID) X (.621 OD) X (.063 THK.)
6	20	0398-061-091-6X		SCREW BUTTON HEX (M6 x 1.0 x 10)
7	1	3201-000-001-XX	03	LOWER TRAY
8	3	1558-BUD-P00-86		GROMMET BUNA-N RUBBER (1.50LD) X (2.13 OD) X (.5"THK)
9	1	3201-000-005-XX	00	ACCESS PANEL
10	1	3201-000-060-XX	02	REAR PANNEL WELDED ASSY
11	1	3201-000-006-XX	02	SIGN PANEL
12	4	198X-265-100-35		WASHER M4 (.172 ID) X (.347 OD) X (.031 THK.)
13	4	1200-034-007-5X		NUT KEP (.6732"X.109)
14	2	3201-000-015-XX	01	LIPPER COVER
15	1	3201-000-003-XX	05	FRONT COVER
16	16	1070-079-015-0X	N/A	NUT LOCK NYLON INSERT M8X1.25 X 8
17	2	0031-000-001-07		DURABLE SUPERIOR CASTERS (SWIVEL)
18	2	0031-000-001-08		DURABLE SUPERIOR CASTER (LOCKING)
19	1	3201-000-008-XX	00	SIGN PANEL BACKING PLATE

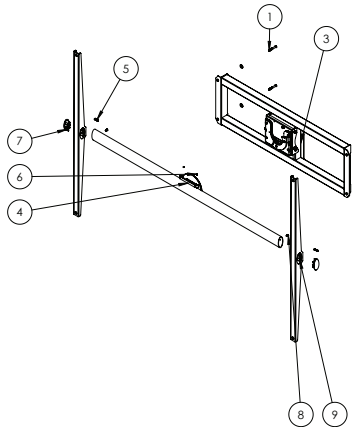

ITEM NO.	QTY.	PART NO.	REV.	DESCRIPTION
1	4	0411-079-320-6X		SCREW BUTTON HEX (M8 x 1.25 x 60)
2	4	201X-50A-B00-55		WASHER LG O.D M8 (.335 ID) X (.934 O.D) X (.079)
3	1	3201-000-070-XX	02	85"- 103" FLAT PANEL ROLLING CART BACK PLATE
4	1	3106-000-035-XX	02	SWIVEL TUBE ASSEMBLY (LARGE)
5	4	1658-079-091-6X		SET SCREW CUP POINT (M8 X 1.25 X 10)
6	2	1658-052-061-6X		SET SCREW CUP POINT (M5 X 0.8 X 6)
7	2	6095-PSD-E-E	00	PLASTIC CAP (ELLIPTICAL TUBE 3.149 X 1.574)
8	2	0474-061-104-6X		SCREW PAN PHILLIPS COMB (M6X1.0 X 12)
9	2	3104-000-038-XX	01	MOUNTING BRACKET ASSEMBLY XLARGE (ELLIPTICAL)

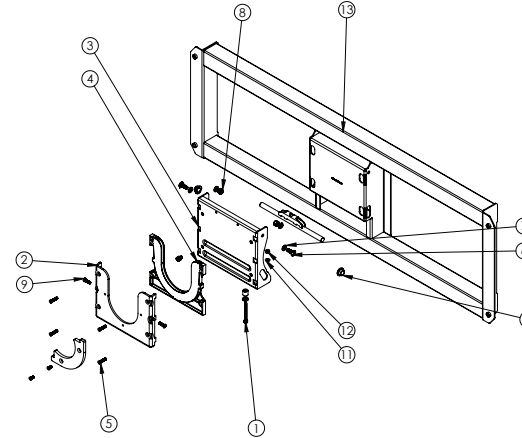

ITEM NO.	QTY.	PART NO.	REV.	DESCRIPTION
1	1	0472-061-520-9X		HEX FULLY THREADED M6x1.0x60
2	1	3106-000-019-XX	02	FRONT COVER (ROTATION BEARING)
3	1	3106-000-018-XX	03	ROTATIONAL MOUNT BRACKET
4	1	6441-10-RUM-RFC	01	RUM FRONT COVER
5	4	0422-061-182-6X		SCREW FLAT 90 DEGREES PHILLIPS (M6 x 1.0 x 25)
6	2	0474-079-153-6X		SCREW PAN PHILLIPS COMB (M8X1.25 X 20)
7	4	198X-507-600-50		WASHER M8 (.335 ID) X (.621 OD) X (.063 THK.)
8	2	1070-079-015-0X	N/A	NUT LOCK NYLON INSERT M8X1.25 X 8
9	2	0474-061-153-6X		SCREW PAN PHILLIPS COMB (M6X1.0 X 20)
10	1	199X-447-700-50		1/4" WASHER SAE (286 ID) X (.430 OD) X (.065 THK.)
11	1	198X-396-200-50		WASHER M6 (.256 ID) X (.464 OD) X (.060 THK.)
12	1	1070-061-012-9X		NYLON INSERT HEX LOCK NUT (M6x1.0x.236) DIN 985
13	1	3201-000-080-XX	02	85"- 103" FLAT PANEL ROLLING CART BACK PLATE
14	1	3106-000-024-XX	00	ROTATIONAL STOP
15	2	0422-061-104-6X		SCREW FLAT 90 DEGREES PHILLIPS (M6 x 1.0 x 12)
16	1	180X-063-117-70		SPACER NYLON 6/6 (250 ID) X (.555 OD) X (.551 THK)
17	1	3106-000-040-XX	00	1/2" TILT ROD WELDED ASSY
18	2	2303-657-601-60		FLG BUSH BRONZE SAE 863 (.500 ID X .625 O.D X .375 LG X .8
19	1	0562-061-077-XX	00	SCREW KNURL KN08 PHILLIPS (M6X1.0 X 8)